

801 Warrenville Road
Suite 560
801 Warrenville Road, Lisle, IL 60532



SUITE FEATURES

- Marketing Flyer.801.Suite 560
- Brand New Spec Suite Now Available!
- Partially furnished
- Nice conference room
- 3 offices with desks
- Space for 4-6 workstations

FIFTH FLOOR PLAN



DETAILS

Square Feet: 1,529 S.F.
Net Rent: \$14.50/S.F.
OP. Expense: \$7.96/S.F.
Tax: \$2.77/S.F.
Gross Rent: \$26.35/S.F.

SPACE PLAN

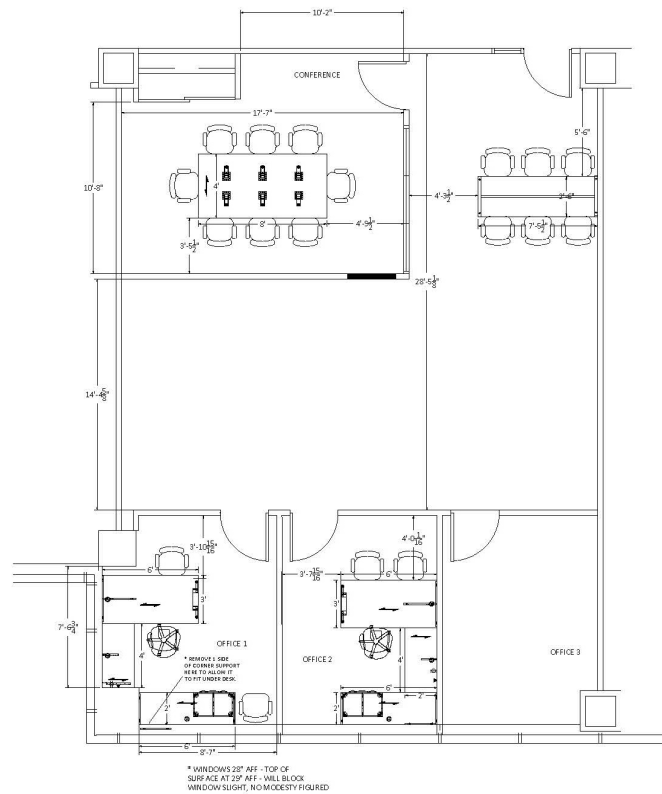

HAMILTON PARTNERS - Sponsoring Broker

David Andrews

✉ da@hpre.com

C 6303270566

Philip Sheridan

✉ phil_sheridan@hpre.com

P 6307195567

C 6303032108