

1250 Greenbriar Drive  
MBP #2 (Suite C)  
1250 Greenbriar Drive  
Addison, IL 60106



### SUITE FEATURES

- Total building square footage is 147,528 S.F.
- 400 amps @ 480 volts
- 4 load levelers
- May be expanded, one additional dock
- Superior office/distribution space is available for lease at Meadows Business Park in Addison. Each building features quality construction and unique architectural detailing. In its wooded setting this single-story building provides an excellent working environment.
- Professional property management is provided by Hamilton Partners, Inc.
- Easy access to O'Hare International Airport and Metropolitan Chicago via Highway 53, I-290 and I-355.

### DETAILS

<b>Square Feet:</b>	23,325 S.F.
<b>Office Square Feet:</b>	5,837 S.F.
<b>Clear Height:</b>	24
<b>Bay Size:</b>	32x40
<b>Exterior Docks:</b>	5
<b>Drive-In Doors:</b>	1

### SITE AND BUILDING PLAN



HAMILTON PARTNERS - Sponsoring Broker

### Industrial Division

Industrial@hamiltonpartners.com

P 630-250-9700

1250 Greenbriar Drive  
MBP #2 (Suite C)  
1250 Greenbriar Drive  
Addison, IL 60106

HAMILTON PARTNERS  
www.hamiltonpartners.com

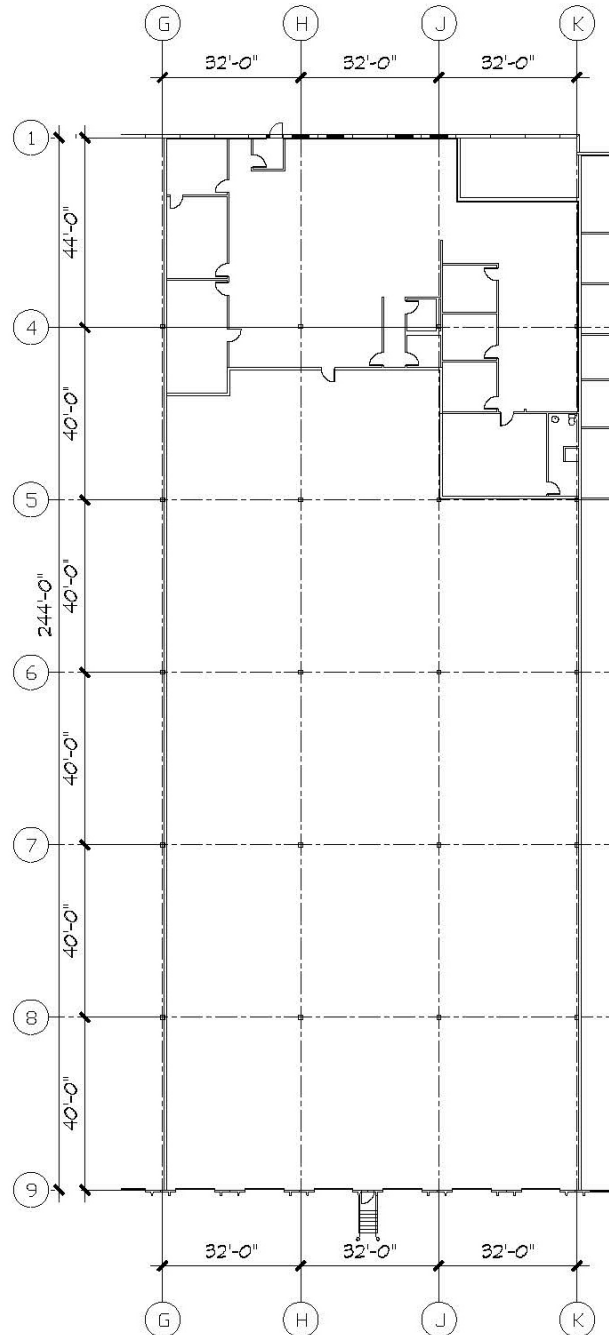

HAMILTON PARTNERS - Sponsoring Broker

Industrial Division

Industrial@hamiltonpartners.com

P 630-250-9700