

1420-1470 Thorndale Ave - EGIP #32

1460 Thorndale
Elk Grove Village, IL 60007



SUITE FEATURES

- Total Building Square Footage is 160,611 SF

DETAILS

Square Feet:	62,846 S.F.
Office Square Feet:	1,800 S.F.
Clear Height:	24'
Exterior Docks:	5
Drive-In Doors:	1

SITE AND BUILDING PLAN

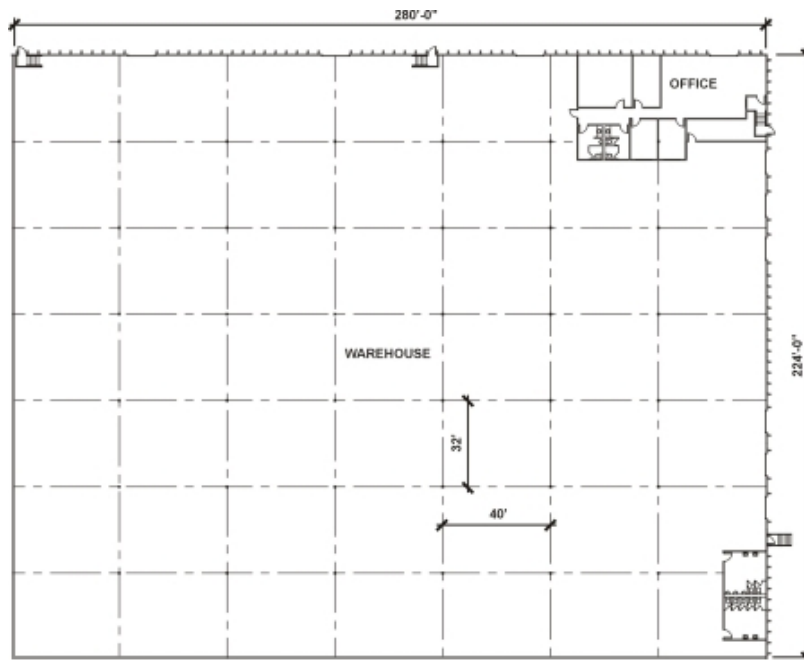

HAMILTON PARTNERS - Sponsoring Broker

Hamilton Partners Industrial Division

Industrial@hamiltonpartners.com

P 630-250-9700

1420-1470 Thorndale Ave - EGIP #32

1460 Thorndale
Elk Grove Village, IL 60007

HAMILTON PARTNERS
www.hamiltonpartners.com

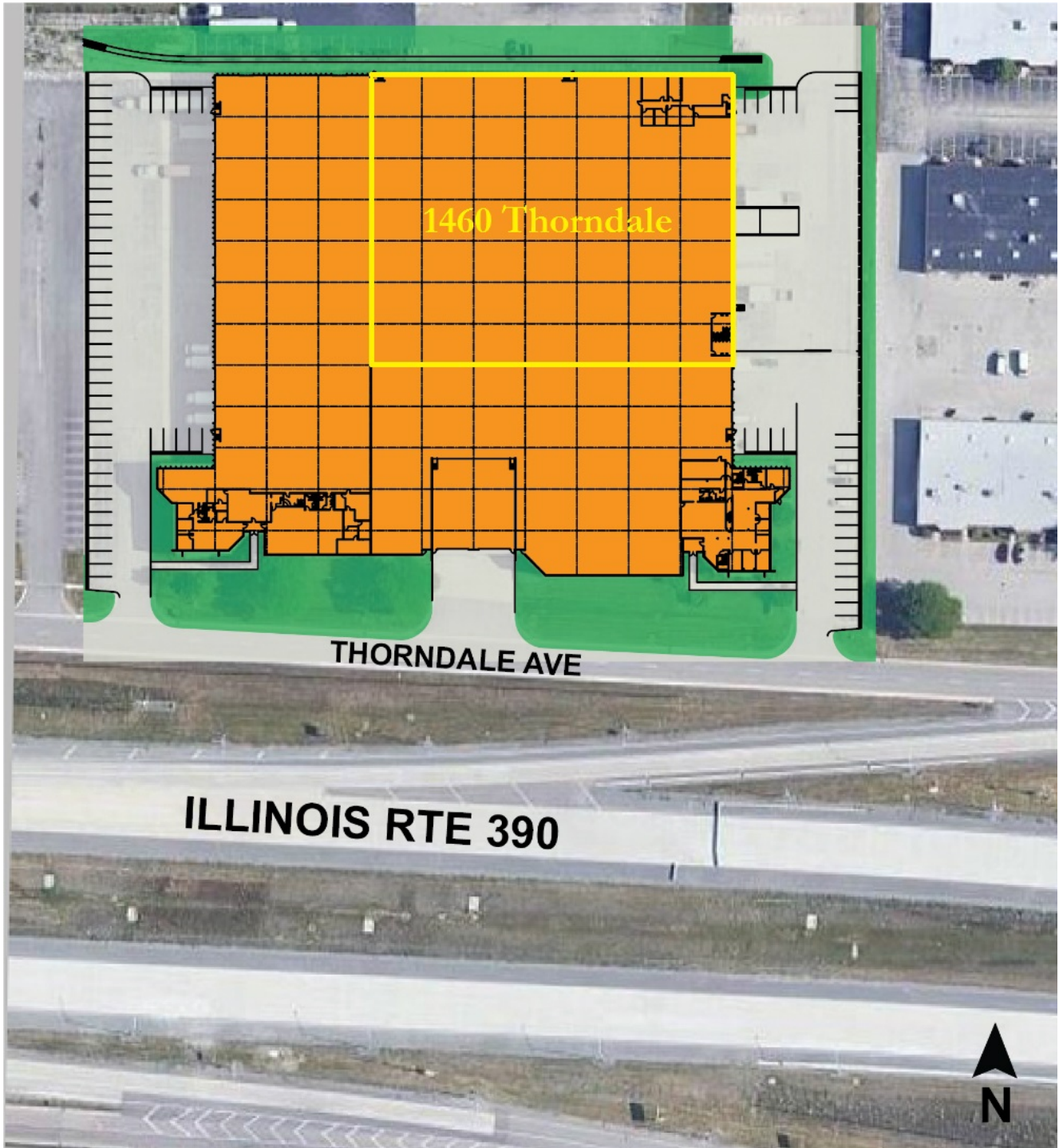

HAMILTON PARTNERS - Sponsoring Broker

Hamilton Partners Industrial Division

Industrial@hamiltonpartners.com

P 630-250-9700