

Esplanade at Locust Point-1.38 Acre
Esplanade Outlot
Downers Grove, IL 60515, United States

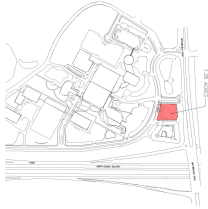

SUITE FEATURES

- Prime 1.38-acre lot at I-355 and Butterfield Road, next to Cooper's Hawk and the Esplanade Office Park, drawing 5,000 visitors daily. High traffic area: 37,400 cars on Butterfield Rd and 129,000 on I-355. Nearby demographics:
 - 1 Mile Radius: 6,988 people, median income \$71,621, average income \$102,465.
 - 3 Mile Radius: 83,144 people, median income \$75,228, average income \$124,972.
 - 5 Mile Radius: 266,242 people, median income \$77,639, average income \$128,105.

DETAILS

Square Feet: 60,112 S.F.

HAMILTON PARTNERS - Sponsoring Broker

David Andrews

✉ da@hpre.com

C 6303270566

Gary Mori

✉ gary_mori@hpre.com

P 630-719-5560

F 630-719-5570

Philip Sheridan

✉ phil_sheridan@hpre.com

P 6307195567

C 6303032108

Esplanade at Locust Point-1.38 Acre
Esplanade Outlot
Downers Grove, IL 60515, United States

HAMILTON PARTNERS
www.hamiltonpartners.com

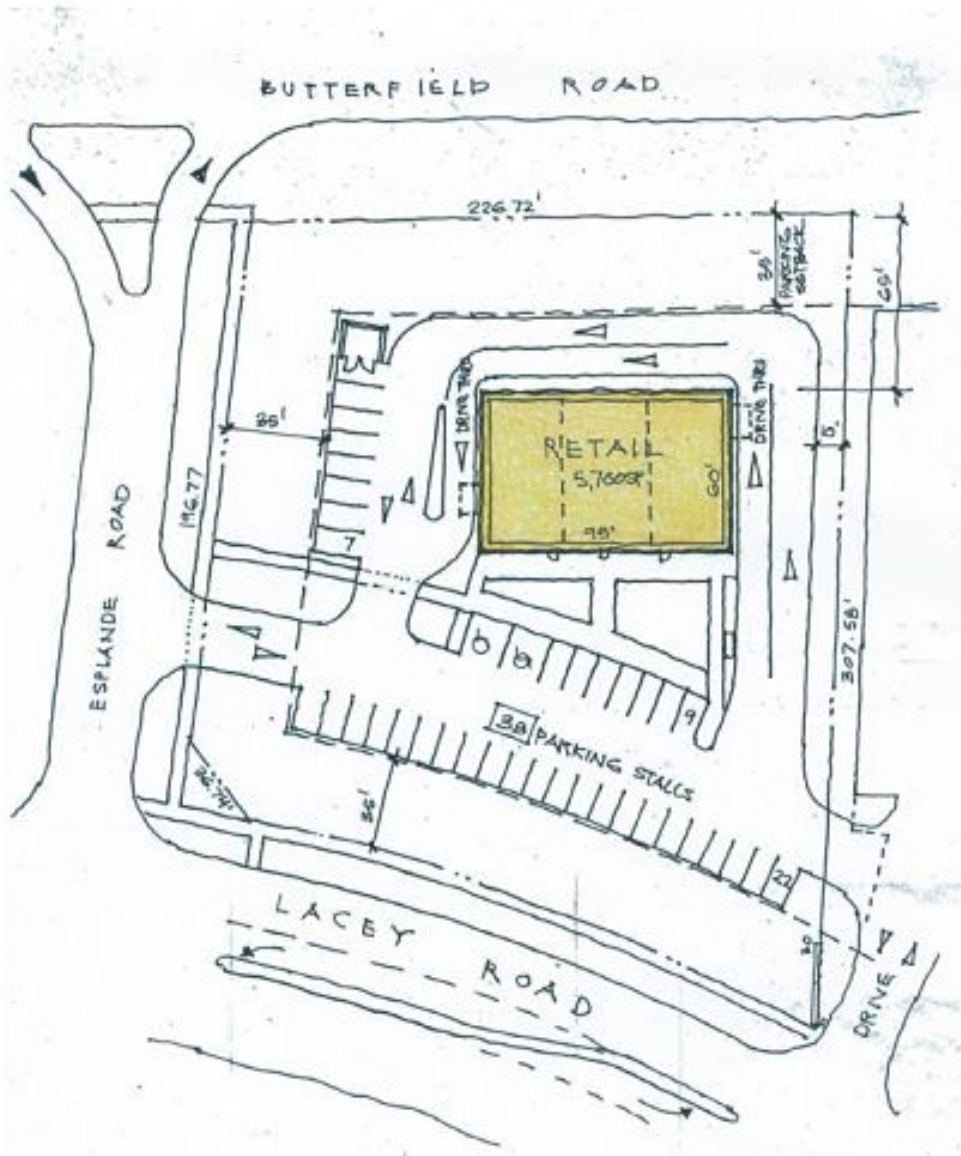

HAMILTON PARTNERS - Sponsoring Broker

David Andrews

✉ da@hpre.com

C 6303270566

Gary Mori

✉ gary_mori@hpre.com

P 630-719-5560

F 630-719-5570

Philip Sheridan

✉ phil_sheridan@hpre.com

P 6307195567

C 6303032108